

PERFILES

E: 1/2

MARCOS

AT45-0400
(RT004)

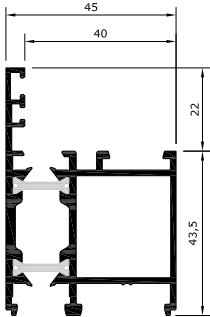

AT45-0100
(RT001)

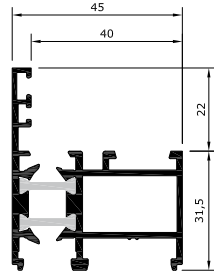

AT45-0101
(RT099)

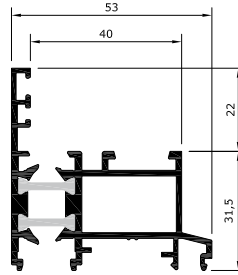

AT45-0209
(RT011)

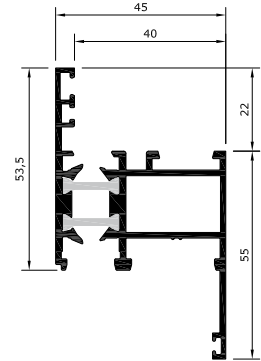

HOJAS APERTURA INTERIOR

AT45-1170
(RT026)

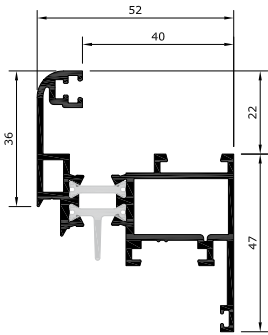

AT45-1190
(RT025)

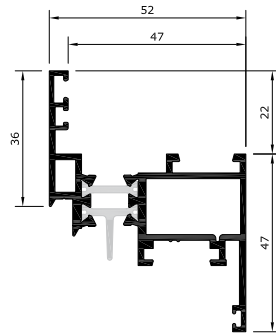

AT45-1477
(RT032)

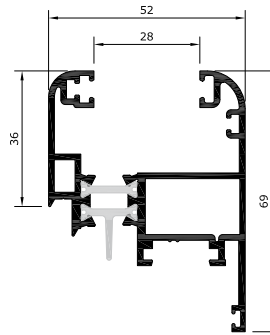

AT45-1260
(RT033)

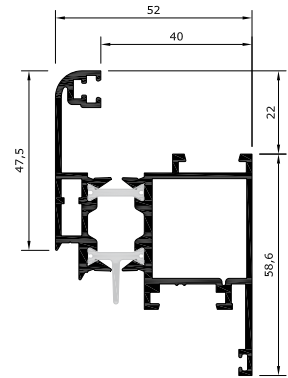

AT45-1290
(RT027)

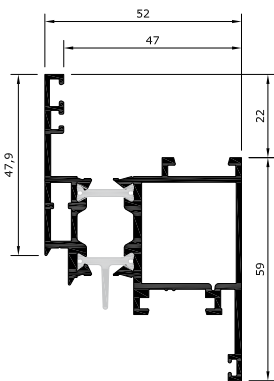

PT45-1360
(RT024)

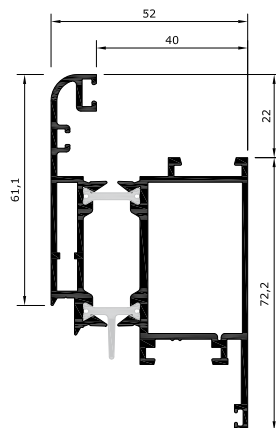

AT45-1390
(RT028)

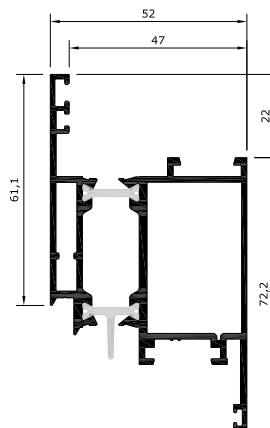

AT45
3



PERFILES

E: 1/2

INVERSORES

AT45-2360

(RT041)

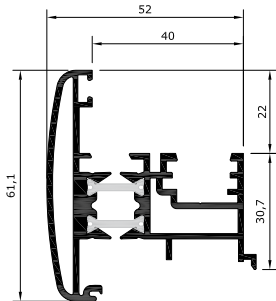

AT45-2390

(RT023)

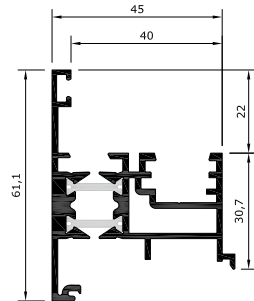

PERFILES ESTRUCTURALES (MONTANTES, TRAVESAÑOS Y ZÓCALOS)

AT45-3140

(RT015)

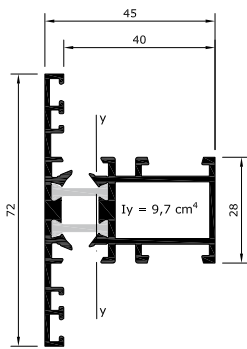

AT45-3340

(RT008)

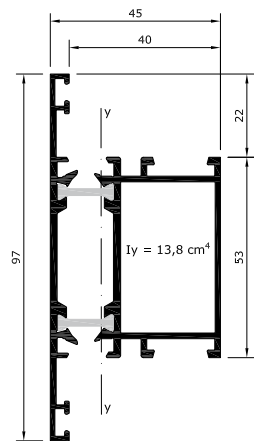

AT45-3000

(RT019)

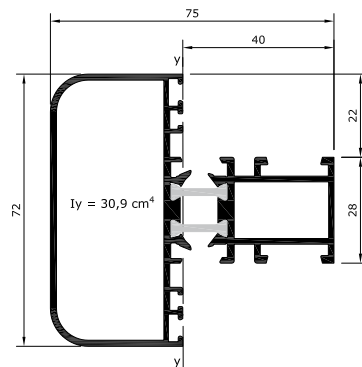

AT45-3440

(RT013)

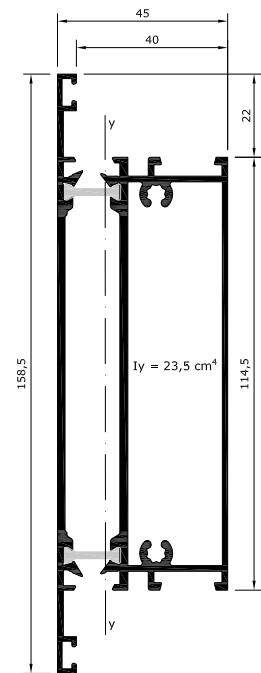

AT45
4

PERFILES

E: 1/2

PERFILES ESTRUCTURALES (MONTANTES, TRAVESAÑOS Y ZÓCALOS)

AT45-3250
(RT010)

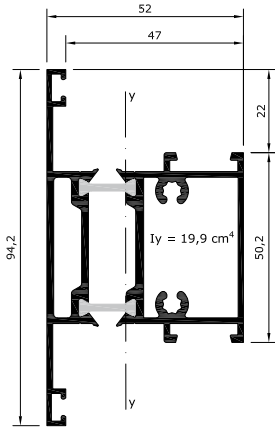

AT45-3450
(RT009)

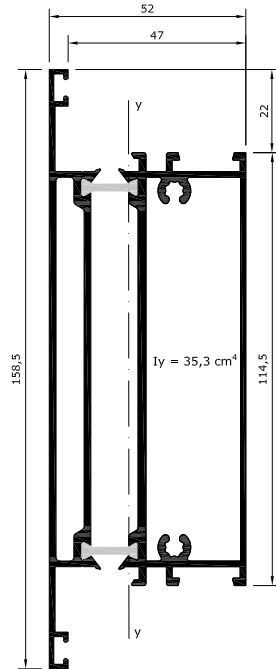

AT45
5

CANTONERAS

AT45-3600
(RT021)

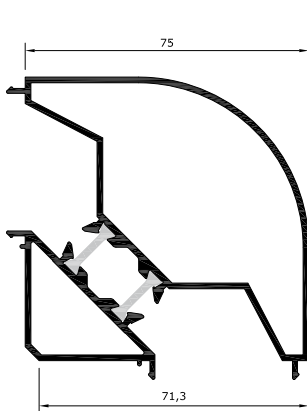

PF43-3660
(61740)

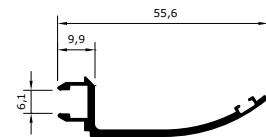

PF43-3661
(61741)

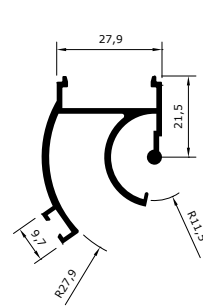

PF43-3662
(61742)

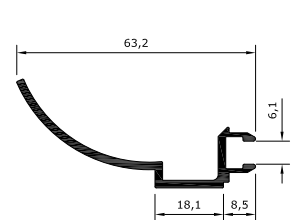

PERFILES AIREADORES

PF43-3663
(61743)

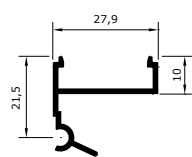

GP07-3693

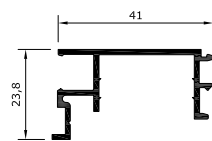

GPM7-3693
mecanizado

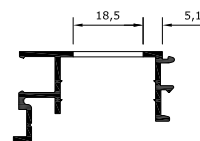



PERFILES

E: 1/2

PERFILES VENTANA PIVOTANTE

AT45-0700
(RT101)

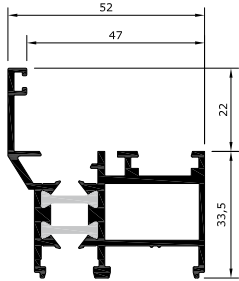

AT45-1700
(RT100)

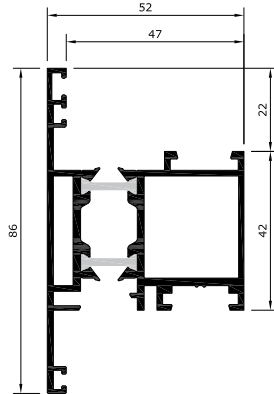

AT45-2700
(61729)

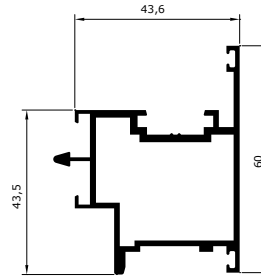

SISTEMA DOBLE-WIN

CP00-0010

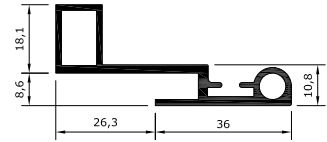

PERFILES PORTICÓN

CP00-9900

XX06-0016

OB30-2390

OM60-7000

XX09-7992
(7992)

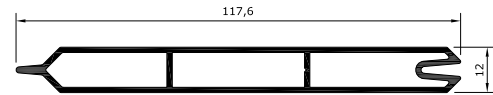
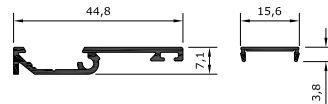
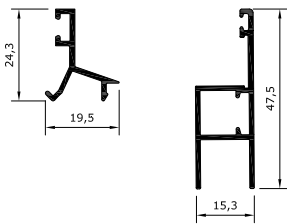

AT45
6

JUNQUILLOS

RELACION JUNQUILLO - GROSOR VIDRIO

		JUNQUILLOS							
		36	31	26	21	18	16	11	3
Opción 1									
	CP00-9936 (59850)	CP00-9931 (59849)	CP00-9926 (58948)	CP00-9921 (58949)		CP00-9916 (59848)	CP00-9911 (59847)	CP00-9903 (70796)	
Opción 2									
	CP00-9936 (59850) CP00-9736 (5066)		CP00-9926 (58948) CP00-9726 (5059)	CP00-9921 (58949) CP00-9721 (5058)		CP00-9916 (59848) CP00-9716 (5057)	CP00-9911 (59847) CP00-9711 (5056)		
Opción 3									
	CP00-9636 (68137) CP00-9836 (67360)		CP00-9626 (64053) CP00-9826 (66236)		CP00-9618 (64246) CP00-9818 (65793)		CP00-9611 (64248) CP00-9811 (66235)		
		HUECO HOJAS RECTAS (mm)							
		11	16	21	26	29	31	36	44
		HUECO MARCOS Y HOJAS CURVAS (mm)							
		4	9	14	19	22	24	29	37